

# MasterSheet

022 0090  
Revision 10/25/16



Complete Car Audio  
Installation Instructions  
**CRUTCHFIELD**

**2000-'09  
Honda S2000**



## IMPORTANT

Before starting, compare items on your invoice with items received. Carefully check through packaging material. If any item is missing, please call **Crutchfield Technical Support** at **1-800-955-9094**.

Although reasonable attempts are made to verify the accuracy of the information contained in this MasterSheet, it is presented without warranties or guarantees of any type due to the constantly changing nature of this type of information and running changes in vehicle production. Any person or entity using this information does so at his or its own risk. If you find our instructions are different from your vehicle, or if you have questions, do not continue with your installation. Contact our toll-free technical support for assistance.

## Inside...



\*0000220090\*

## Page

2	Factory Radio Removal (2000-'03)	✓		✓		
3-4	Factory Radio Removal (2004-'09)	✓		✓		
5	Receiver Installation	✓				
6-7	Door Speakers	✓	✓	✓	✓	
8	Rear Pillar Speakers (2006-'09)	✓	✓	✓	✓	
9	Wire Splicing Guide	✓				✓

## Tools Required ▶

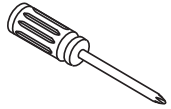
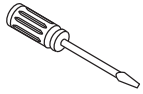
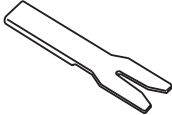
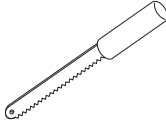
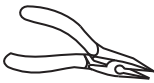
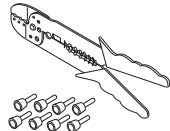
Phillips Screwdriver	Small Flat Blade Screwdriver	Panel Tool	Hack Saw (optional)	Wire Cutters	Wire Strippers & Crimp Caps
					

**Note:** At this time, no aftermarket antenna is available from Crutchfield. A replacement antenna may be purchased from a Honda dealership.

**CRUTCHFIELD**  
Copyright 2016 Crutchfield Corporation

022 0090

# Factory Radio Removal -- 2000-'03 Models

1. Before proceeding, eject disc(s) from factory unit if present.
2. Set parking brake and disconnect negative battery cable to prevent any electrical short.
3. Pry around all edges of receiver/air vents trimpanel to remove (Figures 1-3).
4. Remove four (4) phillips screws securing factory radio. Pull out radio, disconnect and remove (Figure 4).

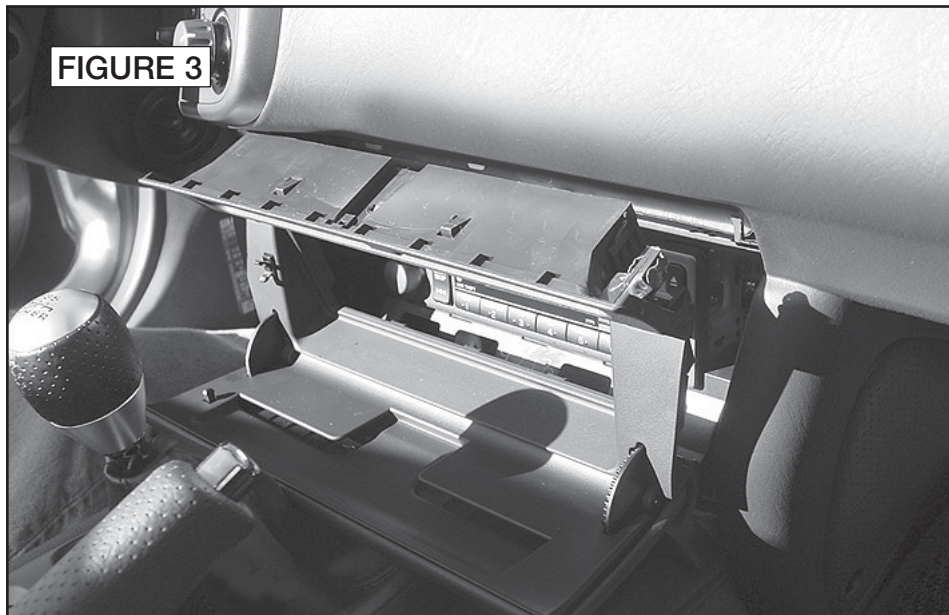



022 0090

# Factory Radio Removal -- 2004-'09 Models

1. Before proceeding, eject disc(s) from factory unit if present.
2. Set parking brake and disconnect negative battery cable to prevent any electrical short.
3. Unscrew gear shift knob to remove (Figure 1).
4. Pry up top console panel to release clips. Disconnect harnesses and remove assembly (Figures 2-4).

*Continued on the next page.*

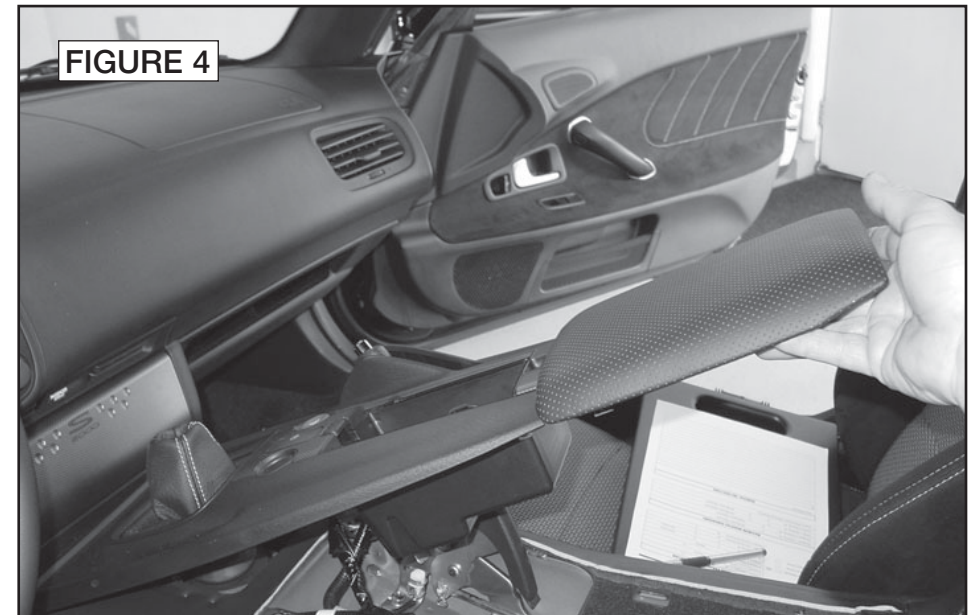
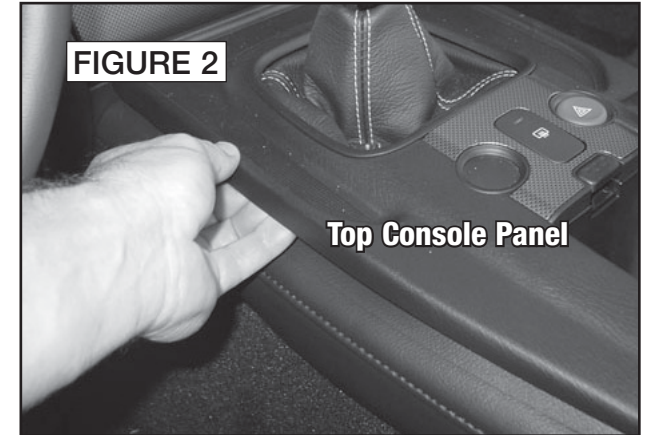

1-800-955-9094  
TECHNICAL SUPPORT

**CRUTCHFIELD**  
Copyright 2016 Crutchfield Corporation

# Factory Radio Removal -- 2004-'09 Models (continued)

5. Pry out radio trim/door assembly to release clips. Disconnect harnesses and remove assembly (Figures 5 & 6).
6. Remove four (4) phillips screws securing factory radio. Pull out radio, disconnect and remove (Figure 7).

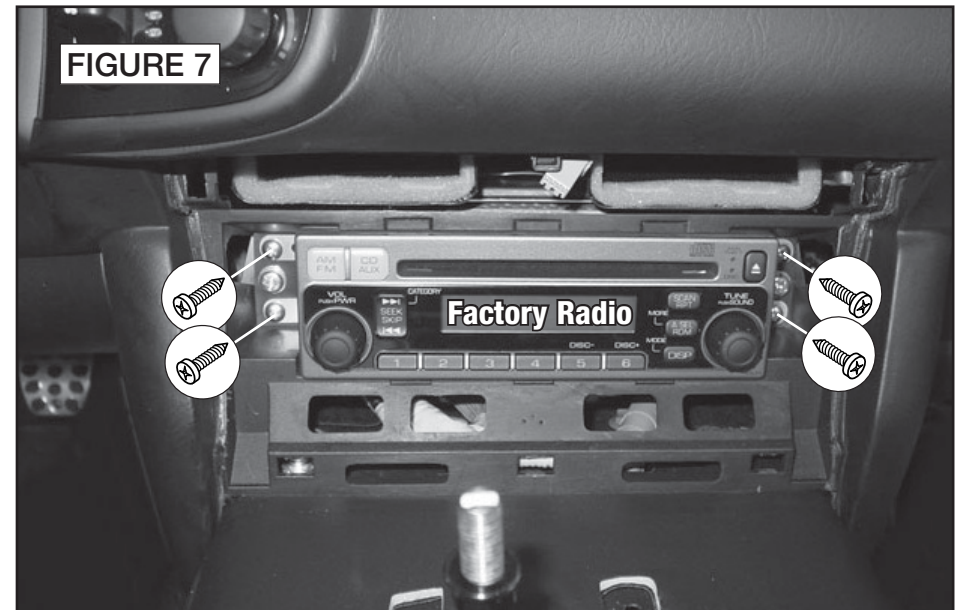
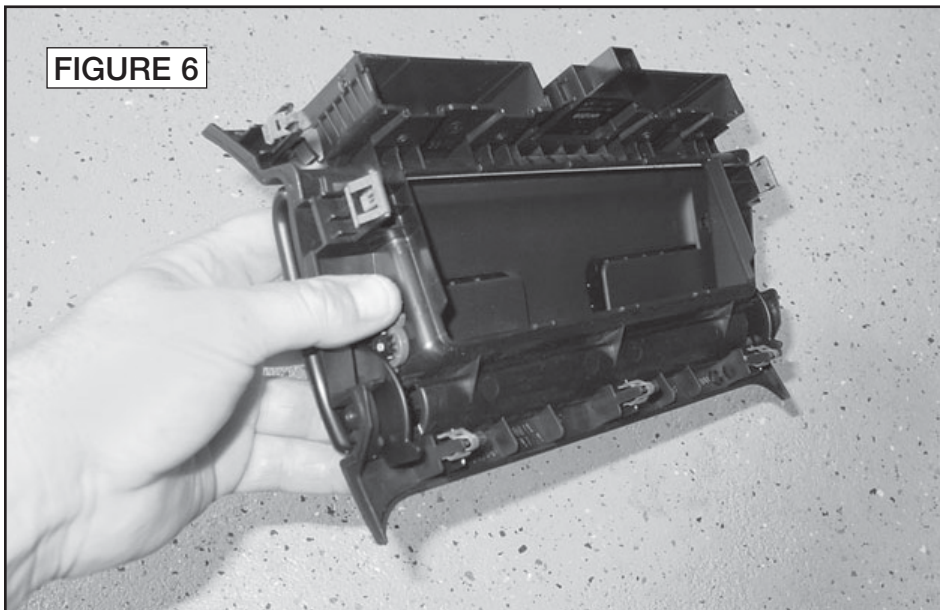



022 0090

# Receiver Installation

## NOTES:

### Please read first

- Check to make sure the Crutchfield receiver wiring adaptor plugs into the vehicle receiver harness. If the Crutchfield adaptor is incorrect, please call our **Technical Support Department at 1-800-955-9094**.

1. Make wiring connections to new receiver following instructions supplied with the receiver wiring adaptor received from Crutchfield.
2. Remove four (4) phillips screws securing factory radio to **side brackets** (two screws on each side of radio - Figure 1).
3. Remove **DIN sleeve** from new receiver (Figure 2). **Note:** Sleeve will not be used in this application.
4. Place factory side brackets on sides of new receiver. Align **mounting holes** on replacement receiver with holes in factory side brackets. Secure receiver in the same manner as factory radio using screws supplied with new receiver (Figure 3).
5. Hold receiver assembly near dash. Connect receiver wiring adaptor to vehicle harness and plug antenna lead into rear of receiver. Secure receiver assembly with screws previously removed.
6. Test receiver operation and reassemble dash by reversing disassembly steps.
7. Install receiver trim ring.

FIGURE 1

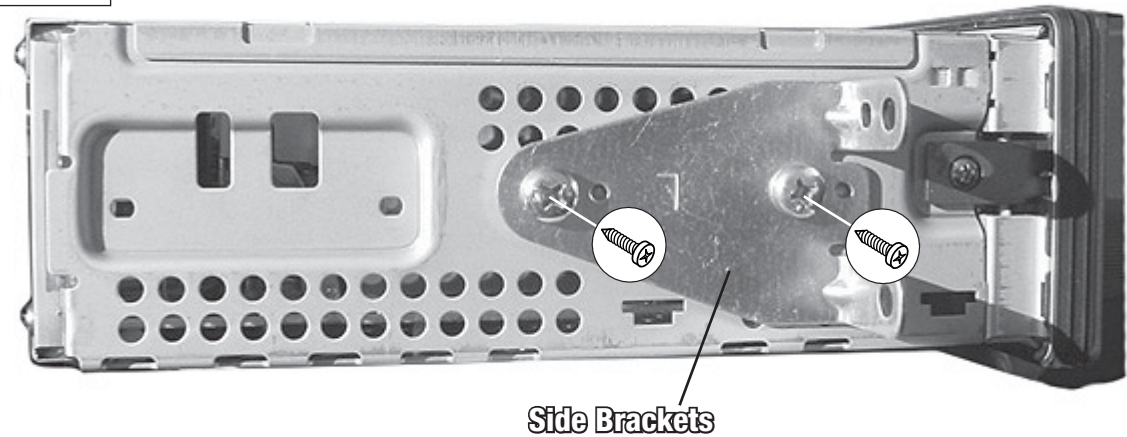

FIGURE 2

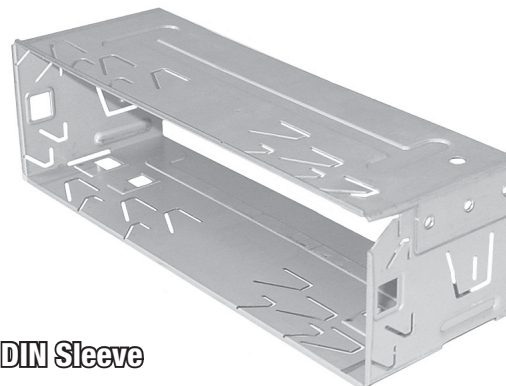
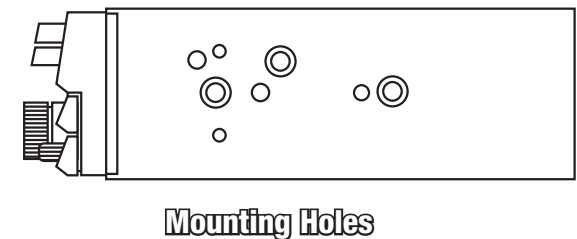

FIGURE 3



1-800-955-9094  
TECHNICAL SUPPORT

**CRUTCHFIELD**

Copyright 2016 Crutchfield Corporation

# Door Speakers

## NOTES:

### Please read first

- Instructions show factory size speakers or speakers with adaptor brackets only. Cutting or fabrication (not shown) will be required for other speaker sizes.



### IMPORTANT

No speaker wiring adaptor is available at this time from Crutchfield for the tweeter location. It will be necessary to splice wires in order to install an aftermarket speaker.

No speaker adaptor bracket is available at this time for the tweeter location. A mounting bracket must be fabricated in order to install an aftermarket speaker.

It is possible that the replacement speakers do not have screws supplied. It may be necessary to acquire mounting hardware.

1. Pry out two (2) screw covers in door pull handle and remove exposed phillips screws (Figures 1-3).
2. Pry out one (1) retaining clip located in upper front edge of door panel (Figure 4).
3. Remove one (1) phillips screw located in door release trim. Pull trim toward rear of vehicle and remove (Figures 5 & 6).

*Continued on the next page.*

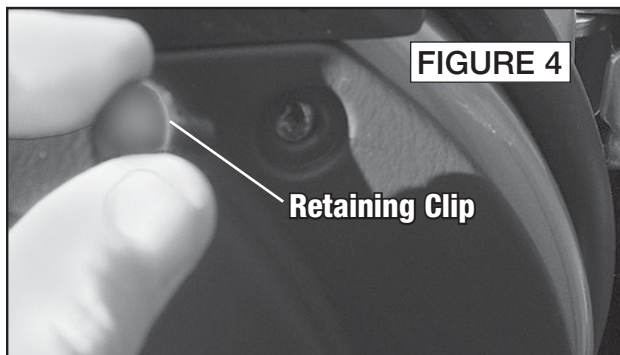
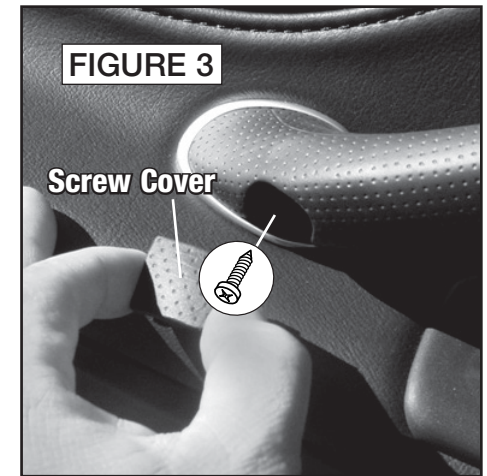
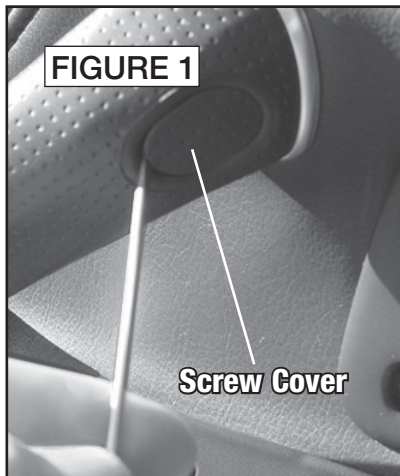

1-800-955-9094  
TECHNICAL SUPPORT

**CRUTCHFIELD**  
Copyright 2016 Crutchfield Corporation



## Door Speakers (continued)

4. Pry out sides and bottom of door panel to release retaining clips. Lift panel and pull outward enough to disconnect wiring harnesses. Remove door panel (Figure 7).

### 5a. Tweeter Removal & Installation:

- Remove two (2) phillips screws from speaker/bracket assembly. Disconnect wiring and remove assembly. Remove one (1) phillips screw securing speaker to bracket (Figure 8).
- Fabricate a speaker mounting bracket and secure new speaker to bracket.
- Make wiring connections following instructions on page 9. Return to this page to complete installation.
- Secure speaker/bracket assembly to location.

### 5b. Woofer Removal & Installation:

- Remove three (3) phillips screws securing speaker. Pull out speaker, disconnect and remove (Figure 9).
- Test fit replacement speaker. If greater depth is needed for replacement speaker, remove four (4) phillips screws securing factory speaker bracket and cut out rear portion of bracket. Reinstall bracket (Figure 10).
- Connect speaker wiring adaptor of replacement speaker to vehicle speaker harness.
- Secure new speaker with screws previously removed.

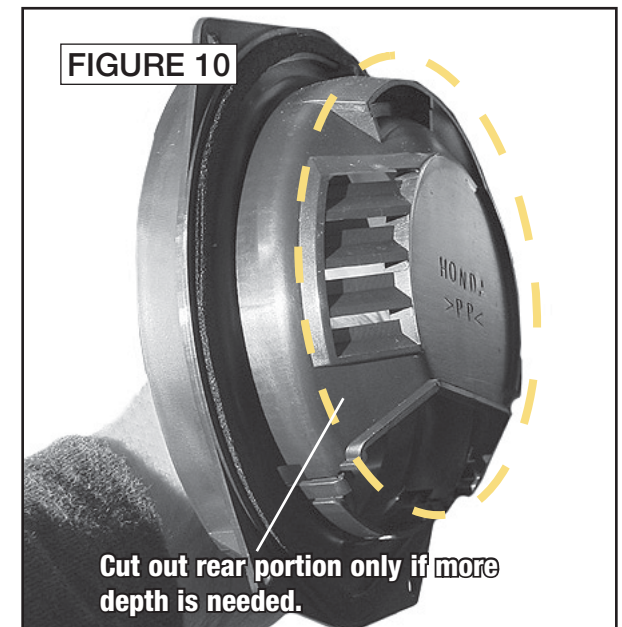
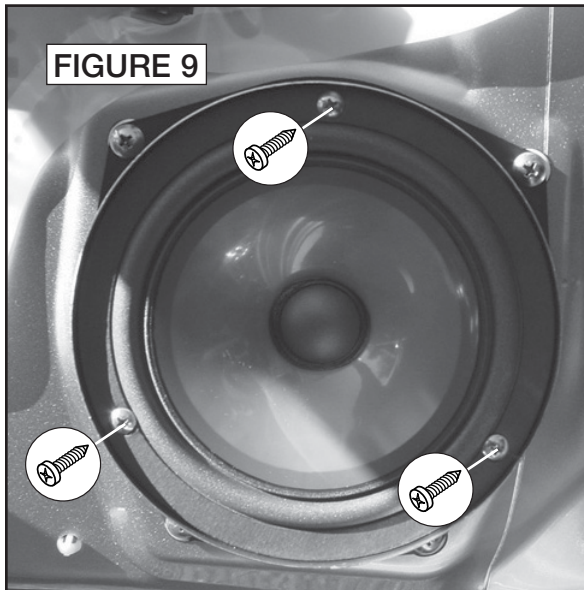
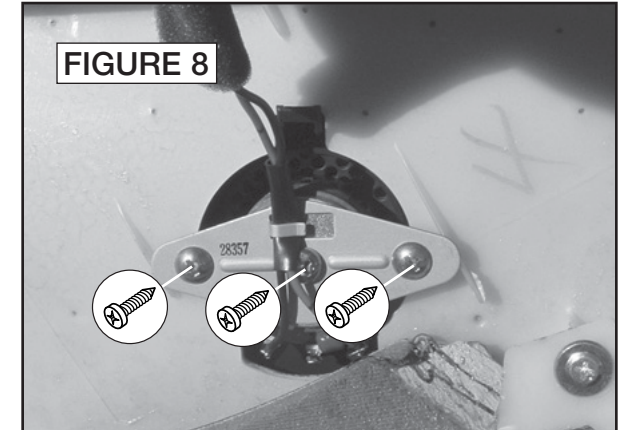

**SAFETY CHECK**

- Check that wires do not interfere with window operation.
- Test door lock and release operation.

**1-800-955-9094**  
**TECHNICAL SUPPORT**

022 0090

## Rear Pillar Speakers -- 2006-'09

### NOTES:

#### Please read first

- Instructions show factory size speakers or speakers with adaptor brackets only. Cutting or fabrication (not shown) will be required for other speaker sizes.



### IMPORTANT

The speaker in this location is in a small sealed enclosure. Speaker harness location is difficult to access. Cutting wires and splicing is recommended. It will be necessary to fabricate a speaker mounting bracket in order to install an aftermarket speaker in this location.

1. Pry off speaker grille at pry point to release clips and remove (Figure 1).
2. Remove two (2) phillips screws securing speaker to pillar. Cut wires and remove speaker (Figure 2).
3. Connect vehicle speaker wires to new speaker using spade connectors.
4. Test speaker operation and reinstall grille.



1-800-955-9094  
TECHNICAL SUPPORT

**CRUTCHFIELD**

Copyright 2016 Crutchfield Corporation



# Wire Splicing Guide

*These methods can be used to make wiring connections if no receiver or speaker wiring adaptor is available.*

## CRIMP METHOD

*Factory harness is removed. Save harness if it is to be reconnected in the future by this method.*

1. Cut factory wires behind factory speaker harness.

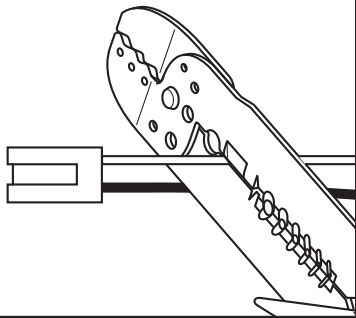

2. Strip end of each wire back 1/2".

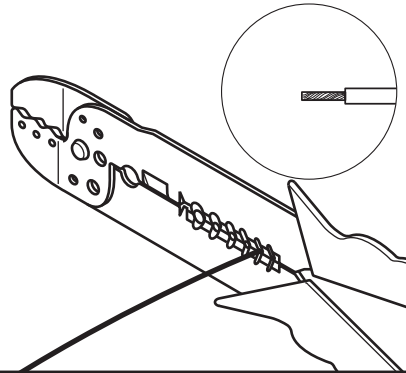

3. Twist each positive pair of wires together and insert in crimp cap. Repeat step for negative wires.

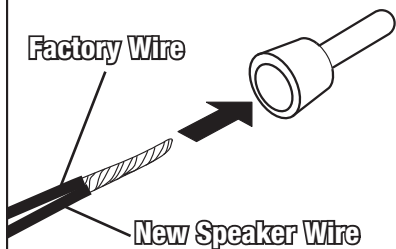

4. Squeeze middle of cap for tight connection.
5. Connect new wires to speaker with spade connectors.

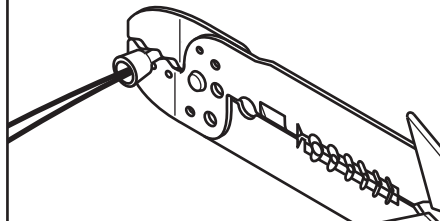

## SOLDER METHOD

*New speaker wires are spliced into factory wires behind harness.*

1. Carefully strip out a 1/2" section on each factory speaker wire behind the factory speaker harness.

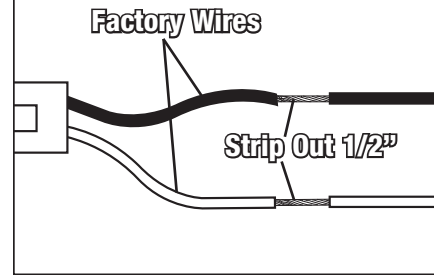

2. Twist wires from new speaker to stripped sections of factory wires as shown making sure polarity is correct.

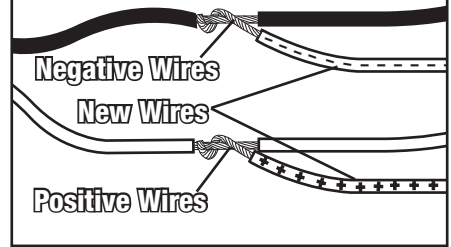

3. Heat wires first with soldering iron, then touch solder to wires for solid connections.

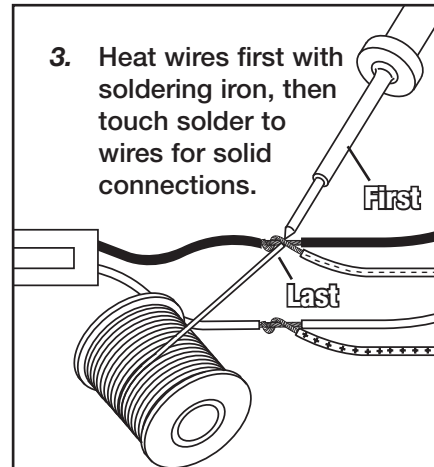

4. Wrap wiring connections with electrical tape.
5. Connect new wires to speaker with spade connectors.

